

Installation and Use Instructions

Pressure Sensing Floor Mat

Item # AFM-07 Corded, 24" x 48"
Item # CLFMATT-07C, Cordless,
with Trans 24" x 48"

- Great for monitoring at bedside or in doorway
- Available in CordLess® & Corded options

drive™



Corded & CordLess® Pressure Sensing Floor Mats

WARNING: Failure to comply with warning may result in injury or death. This device is not suitable for all individuals. Other devices may be required. This device is not a substitute for visual monitoring by caregiver. The manufacture does not claim that this device will stop elopement and/or stop falls. This device is designed to augment caregivers comprehensive resident mobility monitoring program. Test this device before each use. [Read the instructions and Legal Disclaimer.](#)

The Drive Corded and CordLess® Fall Prevention Monitors are designed to be installed by the end user. Such as the entire responsibility of the buyer to ensure that the system is properly installed and tested. Further, the system is not designed to replace good care giving practices including but not limited to:

- A.) Direct patient supervision
- B.) Adequate training for staff personal for fall prevention and elopement
- C.) Testing of the system before each use

WHERE PERMISSIBLE, IT IS THE SELLER'S INTENT TO LIMIT ANY LIABILITY FOR SPECIAL, CONSEQUENTIAL OR INCIDENTAL ECONOMIC DAMAGES TO REFUND OF THE PURCHASE PRICE OR REPLACEMENT OF THE GOODS. SELLER DISCLAIMS ANY LIABILITY FOR COMPENSATORY OF OTHER DAMAGES ARISING OUT OF THE USE OF THE GOODS.

WARNING: The manufacture does not claim that this device will stop elopement and/or stop falls. This device is designed to augment caregivers comprehensive resident mobility management program. This product is to be used by a licensed caregiver only.

Limited Warranty: Seller warrants that the goods sold will be free from defects of workmanship and manufacturing, for a period of one year from the date of sale. Other than this limited warranty, seller makes no express or implied warranties. Except for this limited warranty, NO EXPRESS OR IMPLIED WARRANTIES ARE GIVEN AND NO AFFIRMATION OF SELLER, BY WORDS OR ACTION, WILL CONSTITUTE A WARRANTY. THE GOODS BEING PURCHASED ARE BEING SOLD ON A "WITH ALL FAULTS" BASIS. THE ENTIRE RISK AS TO THE QUALITY AND PERFORMANCE OF THE GOODS IS WITH THE BUYER. SHOULD THE GOODS PROVE DEFECTIVE FOLLOWING THEIR PURCHASE, THE BUYER, AND NOT THE MANUFACTURE, DISTRIBUTOR OR RETAILER, ASSUMES THE ENTIRE COST OF ALL NECESSARY INSTALLATION, SERVICING OR REPAIRS.

drive™

Drive Medical Design & Manufacturing
99 Seaview Boulevard, Port Washington, NY 11050
www.drivemedical.com

Pressure Sensing Floor Mat with Corded or CordLess® Options

Corded Option

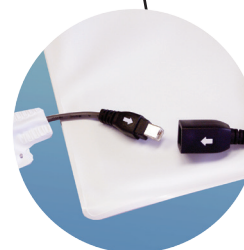
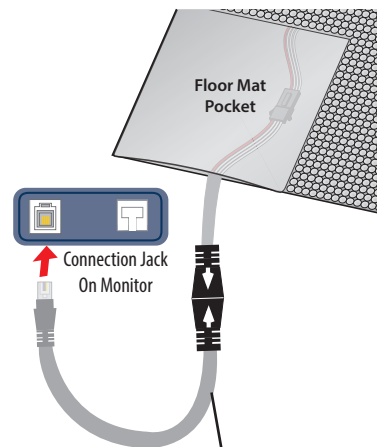

SafeTRelease™ Cord reduces tripping hazards. Cords can be replaced if broken.

CordLess® Option

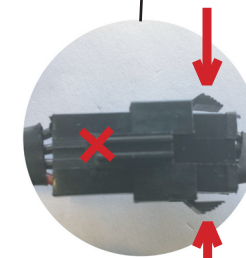
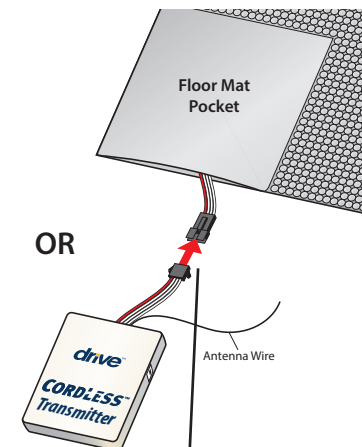

For Replacement Transmitter:

To disconnect, squeeze tabs together on sides of connector while pressing tab on top of the connector and pull apart.

(See reverse side for step by step instructions)

If you are currently using corded floor mats and want to convert to CordLess®, please call.
Need Set-up Help? (866) 621-4933

CordLess® Floor Mat Instructions

1. Programming Floor Mats

The FGCLM-100G CordLess® Monitor may be used with CordLess® Floor Mats. To program a CordLess® Floor Mat:

1. Connect a CordLess® transmitter to a CordLess® Floor Mat (Figure 1).
2. Press and hold the Program Button on the back of the FGCLM-100G CordLess monitor until you hear 3 short beeps to enter programming mode. Release the button. The Status 1 LED light on the front of the monitor will remain lit for (30 seconds).
3. Turn on the CordLess® Transmitter that is connected to the floor mat. The red Status light on the transmitter will light up. (Figure 2)

For single pad use, press the reset button on the monitor to exit programming mode. The system is ready to use. Or....

OPTIONAL: PROGRAM A SECOND PAD OF FLOOR MAT

After programming Pad 1, the Pad 2 LED light will glow for 30 seconds, and the monitor will produce 2 short beeps, indicating that the monitor is ready to program a second floor mat or pad.

For pressure pads: Place pressure on the second pad to program to Pad 2.

Release the pressure.

For a second floor mat, repeat step 3 above.

Press the Reset button to exit programming mode. The system is ready to use.

2. Floor Mat Operation

Important Note: In order for the CordLess® floor mat and monitor to fully reset, there must be a 15 second period with no pressure placed on the mat.

If pressure is placed on the floor mat before this 15 second period is complete, the monitor will produce a low volume alert and the Pad Lost light will blink. (This 15 second period allows a caregiver to assist a resident at a bedside while standing on the floor mat, but without the full volume alert continuing).

- During this 15 second period, the Reset button may be pressed again to silence the low volume alert and stop the Pad Lost light from blinking.
- After 15 seconds with no pressure on the floor mat the system will fully reset.

Test the system before each use (Figure 3):

1. Step on the floor mat
2. The alert will sound
3. Step off the floor mat
4. Press the Reset button to reset the system

3. Mounting the CordLess® Monitor

The FGCLM-100G CordLess Monitor may be placed up to 50 feet away from the pad. Mounting hardware is included for bed or wall mounting.

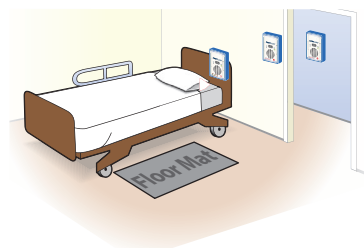
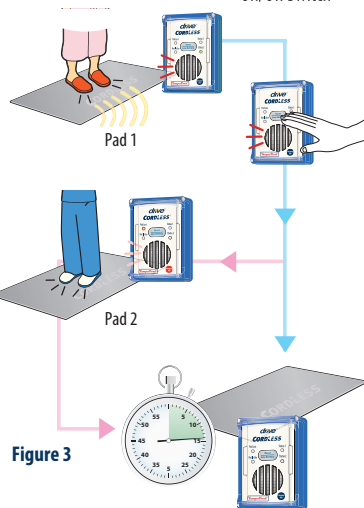
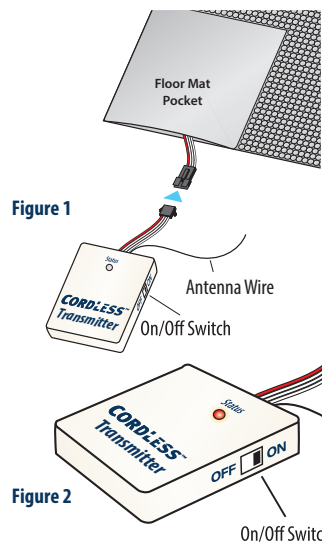

Corded Floor Mat Instructions

1. Install batteries into monitor

The battery compartment door is secured with the included Philips-head screw.

Optional Setting Adjustment

Refer to the user instructions included with your Smart Caregiver fall monitor for detailed setup information.

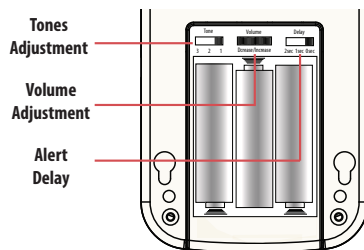

3. Test the system

Step on the floor mat. The alert will sound. Press the Reset button to silence and reset the monitor.

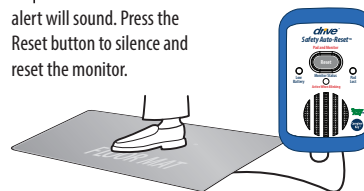

2. Connect the Floor Mat to the Fall Monitor

A. Pinch the cord together and route it through the strain relief recess.

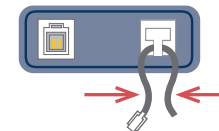

B. Plug the cord into the monitor

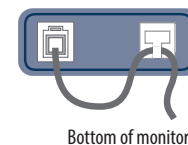

4. Mounting the fall monitor

1. Mount screws in headboard or wall.
2. Hang the monitor on the screw using the mounting hole on the back of the monitor.

